

GARDA

Технические характеристики

По вопросам продаж и поддержки обращайтесь:

Алматы (7273)495-231	Калининград (4012)72-03-81	Омск (3812)21-46-40	Сыктывкар (8212)25-95-17
Ангарск (3955)60-70-56	Калуга (4842)92-23-67	Орел (4862)44-53-42	Тамбов (4752)50-40-97
Архангельск (8182)63-90-72	Кемерово (3842)65-04-62	Оренбург (3532)37-68-04	Тверь (4822)63-31-35
Астрахань (8512)99-46-04	Киров (8332)68-02-04	Пенза (8412)22-31-16	Тольятти (8482)63-91-07
Барнаул (3852)73-04-60	Коломна (4966)23-41-49	Петрозаводск (8142)55-98-37	Томск (3822)98-41-53
Белгород (4722)40-23-64	Кострома (4942)77-07-48	Псков (8112)59-10-37	Тула (4872)33-79-87
Благовещенск (4162)22-76-07	Краснодар (861)203-40-90	Пермь (342)205-81-47	Тюмень (3452)66-21-18
Брянск (4832)59-03-52	Красноярск (391)204-63-61	Ростов-на-Дону (863)308-18-15	Ульяновск (8422)24-23-59
Владивосток (423)249-28-31	Курск (4712)77-13-04	Рязань (4912)46-61-64	Улан-Удэ (3012)59-97-51
Владикавказ (8672)28-90-48	Курган (3522)50-90-47	Самара (846)206-03-16	Уфа (347)229-48-12
Владимир (4922)49-43-18	Липецк (4742)52-20-81	Саранск (8342)22-96-24	Хабаровск (4212)92-98-04
Волгоград (844)278-03-48	Магнитогорск (3519)55-03-13	Санкт-Петербург (812)309-46-40	Чебоксары (8352)28-53-07
Вологда (8172)26-41-59	Москва (495)268-04-70	Саратов (845)249-38-78	Челябинск (351)202-03-61
Воронеж (473)204-51-73	Мурманск (8152)59-64-93	Севастополь (8692)22-31-93	Череповец (8202)49-02-64
Екатеринбург (343)384-55-89	Набережные Челны (8552)20-53-41	Симферополь (3652)67-13-56	Чита (3022)38-34-83
Иваново (4932)77-34-06	Нижний Новгород (831)429-08-12	Смоленск (4812)29-41-54	Якутск (4112)23-90-97
Ижевск (3412)26-03-58	Новокузнецк (3843)20-46-81	Сочи (862)225-72-31	Ярославль (4852)69-52-93
Иркутск (395)279-98-46	Ноябрьск (3496)41-32-12	Ставрополь (8652)20-65-13	
Казань (843)206-01-48	Новосибирск (383)227-86-73	Сургут (3462)77-98-35	
Россия +7(495)268-04-70	Киргизия +996(312)-96-26-47	Казахстан +7(7172)727-132	

Garda
S/90



Low thermal inertia



Low water content



Versatility



Easy to stock and install



16 bar
Maximum working pressure

CE₀₅



Standard supply	3, 4, 5, 6 sections
Colours	RAL 9010 White
Maximum working pressure	16 bar
Test pressure	24 bar
Included in the package	Water diaphragm (retainer cap)

All models **Garda S/90** are guaranteed **10 years** from installation date on manufacturing faults, provided that the installation has been performed in compliance with the current norms and respecting the instructions relating to the installation, the correct use and the correct maintenance as illustrated on this catalogue.

Model	Heat output					
	ΔT 20	ΔT 30	ΔT 40	ΔT 50	ΔT 60	ΔT 70
	W/sect.	W/sect.	W/sect.	W/sect.	W/sect.	W/sect.
900	52,3	90,9	134,4	182,0	233,3	287,7
1000	55,9	97,2	143,9	195,0	250,0	308,5
1200	64,1	111,3	164,6	223,0	285,8	352,5
1400	71,9	124,8	184,6	250,0	320,3	395,1
1600	77,5	135,9	202,4	275,0	354,8	439,2
1800	86,5	150,0	221,6	300,0	384,2	473,6
2000	90,7	159,5	237,9	324,0	418,0	518,0

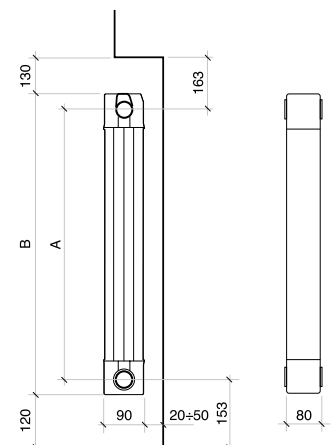

MEASURES EXPRESSED IN MILLIMETRES

Model	Code	Depth	Height	Centre distance	Length	Connection diameters	Water capacity	Exponent	Coefficient
		mm	(B) mm	(A) mm	mm	inches	litres/sect.	n	Km
900	83A014	90	966	900	80	G1	0,43	1,3605	0,8886
1000	83B014	90	1066	1000	80	G1	0,47	1,3630	0,9426
1200	83C014	90	1266	1200	80	G1	0,55	1,3610	1,0864
1400	83D014	90	1466	1400	80	G1	0,62	1,3600	1,2227
1600	83E014	90	1666	1600	80	G1	0,70	1,3843	1,2260
1800	83F014	90	1866	1800	80	G1	0,78	1,3570	1,4846
2000	83G014	90	2066	2000	80	G1	0,86	1,3905	1,4083

Maximum working pressure: 1600 kpa (16 bar)

Characteristic equation of the model $\Phi=K_m \Delta T^n$

Stated heat output values are in accordance with European Standard EN 442-1:2014 and certified by Cetiat - Notified body No. 1623.

Item	Description	Code
	A 72 1/2" Plug/Adapters/Brackets kit, colour white (Rough brackets, not painted): 1 Bleed valve 1/2"; 1 Rh blanking plug; 1 Lh blanking plug; 2 Rh adapters 1/2"; 2 Lh adapters 1/2"; 4 O-ring seals; 2 Supporting brackets	550118
	A 73 3/4" Plug/Adapters/Brackets kit, colour white (Rough brackets, not painted): 1 Bleed valve 3/4"; 1 Rh blanking plug; 1 Lh blanking plug; 2 Rh adapters 3/4"; 2 Lh adapters 3/4"; 4 O-ring seals; 2 Supporting brackets	550119
	A 30/1 Rubber lockshield plug (water diaphragm)	521011
	A 32/1 O-ring seal for nipples, plugs and adapters	530102
	A 33/1 Nipple for home furnishing radiators	521012
	A 36/4 4 Element towel rail - Colour: White RAL 9010	570014
	A 36/5 5 Element towel rail - Colour: White RAL 9010	570024
	A 36/6 6 Element towel rail - Colour: White RAL 9010	570124



Low thermal inertia



Low water content



Versatility



Easy to stock and install



16 bar
Maximum working pressure

Standard supply	3, 4, 5, 6 sections
Colours	RAL 9010 White
Maximum working pressure	16 bar
Test pressure	24 bar
Included in the package	Water diaphragm (retainer cap)

All models **Garda Dual 80** are guaranteed **10 years** from installation date on manufacturing faults, provided that the installation has been performed in compliance with the current norms and respecting the instructions relating to the installation, the correct use and the correct maintenance as illustrated on this catalogue.

Model	Heat output					
	ΔT 20	ΔT 30	ΔT 40	ΔT 50	ΔT 60	ΔT 70
	W/sect.	W/sect.	W/sect.	W/sect.	W/sect.	W/sect.
900	49,7	86,6	128,5	174,4	223,8	276,4
1000	52,9	92,9	138,6	189,1	243,6	301,9
1200	60,2	105,8	157,7	215,0	276,9	343,1
1400	67,6	118,6	176,8	241,0	310,4	384,4
1600	73,9	130,2	194,7	266,0	343,2	425,8
1800	81,1	142,1	211,5	288,0	370,6	458,7
2000	86,7	152,4	227,3	310,0	399,4	494,9

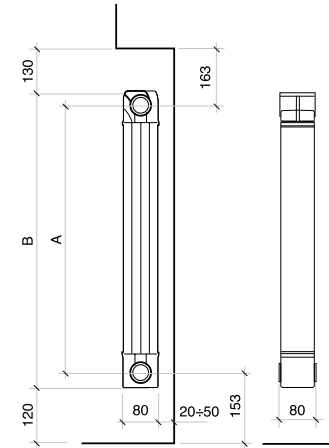

MEASURES EXPRESSED IN MILLIMETRES

Model	Code	Depth	Height	Centre distance	Length	Connection diameters	Water capacity	Exponent	Coefficient
		mm	(B) mm	(A) mm	mm	inches	litres/sect.	n	Km
900	82F014	80	966	900	80	G1	0,47	1,3695	0,8217
1000	82G014	80	1066	1000	80	G1	0,52	1,3908	0,8198
1200	82H014	80	1266	1200	80	G1	0,60	1,3889	0,9391
1400	82I014	80	1466	1400	80	G1	0,70	1,3875	1,0585
1600	82L014	80	1666	1600	80	G1	0,79	1,3980	1,1213
1800	82M014	80	1866	1800	80	G1	0,88	1,3832	1,2864
2000	82N014	80	2066	2000	80	G1	0,96	1,3902	1,3473

Maximum working pressure: 1600 kpa (16 bar)

Characteristic equation of the model $\Phi=K_m \Delta T^n$

Stated heat output values are in accordance with European Standard EN 442-1:2014 and certified by Cetiat - Notified body No. 1623.

Item	Description	Code
	A 72 1/2" Plug/Adapters/Brackets kit, colour white (Rough brackets, not painted): 1 Bleed valve 1/2"; 1 Rh blanking plug; 1 Lh blanking plug; 2 Rh adapters 1/2"; 2 Lh adapters 1/2"; 4 O-ring seals; 2 Supporting brackets	550118
	A 73 3/4" Plug/Adapters/Brackets kit, colour white (Rough brackets, not painted): 1 Bleed valve 3/4"; 1 Rh blanking plug; 1 Lh blanking plug; 2 Rh adapters 3/4"; 2 Lh adapters 3/4"; 4 O-ring seals; 2 Supporting brackets	550119
	A 30/1 Rubber lockshield plug (water diaphragm)	521011
	A 32/1 O-ring seal for nipples, plugs and adapters	530102
	A 33/1 Nipple for home furnishing radiators	521012
	A 36/4 4 Element towel rail - Colour: White RAL 9010	570014
	A 36/5 5 Element towel rail - Colour: White RAL 9010	570024
	A 36/6 6 Element towel rail - Colour: White RAL 9010	570124



Low thermal inertia



Low water content



Versatility



Easy to stock and install



16
bar

Maximum working pressure



Standard supply	3, 4, 5, 6 sections
Colours	PURE WHITE RAL 9010
Maximum working pressure	16 bar
Test pressure	24 bar
Included in the package	Water diaphragm (retainer cap)
Aleternum treatment	Supplied as standard

For technical reasons, in order to ensure the internal Aleternum protection, it is suggested to purchase batteries in the composition needed. Disassembling batteries is strongly not recommended.

All models **Garda 5/90 Aleternum** are guaranteed **20 years** from installation date on manufacturing faults, provided that the installation has been performed in compliance with the current norms and respecting the instructions relating to the installation, the correct use and the correct maintenance as illustrated on this catalogue.

Model	Heat output					
	ΔT 20	ΔT 30	ΔT 40	ΔT 50	ΔT 60	ΔT 70
	W/sect.	W/sect.	W/sect.	W/sect.	W/sect.	W/sect.
900	52,3	90,9	134,4	182,0	233,3	287,7
1000	55,9	97,2	143,9	195,0	250,0	308,5
1200	64,1	111,3	164,6	223,0	285,8	352,5
1400	71,9	124,8	184,6	250,0	320,3	395,1
1600	77,5	135,9	202,4	275,0	354,8	439,2
1800	86,5	150,0	221,6	300,0	384,2	473,6
2000	90,7	159,5	237,9	324,0	418,0	518,0

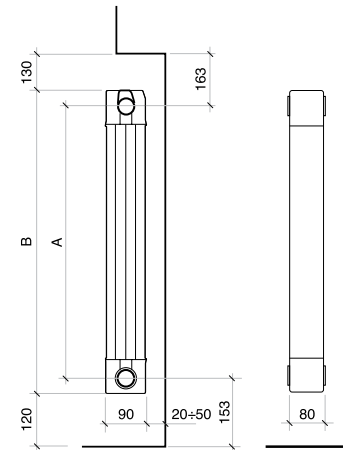









MEASURES EXPRESSED IN MILLIMETRES

Model	Code	Depth	Height	Centre distance	Length	Connection diameters	Water capacity	Exponent	Coefficient
		mm	(B) mm	(A) mm	mm	inches	litres/sect.	n	Km
900	83AA14	90	966	900	80	G1	0,43	1,3605	0,8886
1000	83BA14	90	1066	1000	80	G1	0,47	1,3630	0,9426
1200	83CA14	90	1266	1200	80	G1	0,55	1,3610	1,0864
1400	83DA14	90	1466	1400	80	G1	0,62	1,3600	1,2227
1600	83EA14	90	1666	1600	80	G1	0,70	1,3843	1,2260
1800	83FA14	90	1866	1800	80	G1	0,78	1,3570	1,4846
2000	83GA14	90	2066	2000	80	G1	0,86	1,3905	1,4083

Maximum working pressure: 1600 kpa (16 bar)

Characteristic equation of the model $\Phi=K_m \Delta T^n$

Stated heat output values are in accordance with European Standard EN 442-1:2014 and certified by Cetiat - Notified body No. 1623.

Item	Description	Code
	A 72 1/2" Plug/Adapters/Brackets kit, colour white (Rough brackets, not painted): 1 Bleed valve 1/2"; 1 Rh blanking plug; 1 Lh blanking plug; 2 Rh adapters 1/2"; 2 Lh adapters 1/2"; 4 O-ring seals; 2 Supporting brackets	550118
	A 73 3/4" Plug/Adapters/Brackets kit, colour white (Rough brackets, not painted): 1 Bleed valve 3/4"; 1 Rh blanking plug; 1 Lh blanking plug; 2 Rh adapters 3/4"; 2 Lh adapters 3/4"; 4 O-ring seals; 2 Supporting brackets	550119
	A 30/1 Rubber lockshield plug (water diaphragm)	521011
	A 32/1 O-ring seal for nipples, plugs and adapters	530102
	A 33/1 Nipple for home furnishing radiators	521012
	A 36/4 4 Element towel rail - Colour: White RAL 9010	570014
	A 36/5 5 Element towel rail - Colour: White RAL 9010	570024
	A 36/6 6 Element towel rail - Colour: White RAL 9010	570124

For other accessories, see from page 65



Low thermal inertia



Low water content



Versatility



Easy to stock and install



16 bar Maximum working pressure



Standard supply	3, 4, 5, 6 sections
Colours	PURE WHITE RAL 9010
Maximum working pressure	16 bar
Test pressure	24 bar
Included in the package	Water diaphragm (retainer cap)
Aleternum treatment	Supplied as standard

For technical reasons, in order to ensure the internal Aleternum protection, it is suggested to purchase batteries in the composition needed. Disassembling batteries is strongly not recommended.

All models **Garda Dual 80 Aleternum** are guaranteed **20 years** from installation date on manufacturing faults, provided that the installation has been performed in compliance with the current norms and respecting the instructions relating to the installation, the correct use and the correct maintenance as illustrated on this catalogue.

Model	Heat output					
	ΔT 20	ΔT 30	ΔT 40	ΔT 50	ΔT 60	ΔT 70
	W/sect.	W/sect.	W/sect.	W/sect.	W/sect.	W/sect.
900	49,7	86,6	128,5	174,4	223,8	276,4
1000	52,9	92,9	138,6	189,1	243,6	301,9
1200	60,2	105,8	157,7	215,0	276,9	343,1
1400	67,6	118,6	176,8	241,0	310,4	384,4
1600	73,9	130,2	194,7	266,0	343,2	425,8
1800	81,1	142,1	211,5	288,0	370,6	458,7
2000	86,7	152,4	227,3	310,0	399,4	494,9

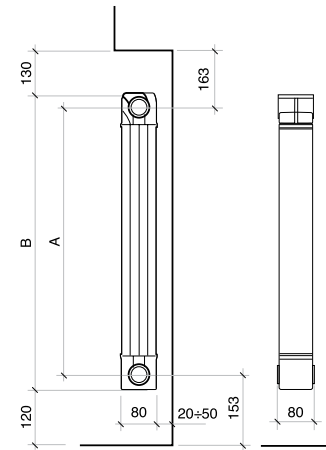

MEASURES EXPRESSED IN MILLIMETRES

Model	Code	Depth	Height	Centre distance	Length	Connection diameters	Water capacity	Exponent	Coefficient
		mm	(B) mm	(A) mm	mm	inches	litres/sect.	n	Km
900	82FA14	80	966	900	80	G1	0,47	1,3695	0,8217
1000	82GA14	80	1066	1000	80	G1	0,52	1,3908	0,8198
1200	82HA14	80	1266	1200	80	G1	0,60	1,3889	0,9391
1400	82IA14	80	1466	1400	80	G1	0,70	1,3875	1,0585
1600	82LA14	80	1666	1600	80	G1	0,79	1,3980	1,1213
1800	82MA14	80	1866	1800	80	G1	0,88	1,3832	1,2864
2000	82NA14	80	2066	2000	80	G1	0,96	1,3902	1,3473

Maximum working pressure: 1600 kpa (16 bar)

Characteristic equation of the model $\Phi=K_m \Delta T^n$

Stated heat output values are in accordance with European Standard EN 442-1:2014 and certified by Cetiat - Notified body No. 1623.

Item	Description	Code
	A 72 1/2" Plug/Adapters/Brackets kit, colour white (Rough brackets, not painted): 1 Bleed valve 1/2"; 1 Rh blanking plug; 1 Lh blanking plug; 2 Rh adapters 1/2"; 2 Lh adapters 1/2"; 4 O-ring seals; 2 Supporting brackets	550118
	A 73 3/4" Plug/Adapters/Brackets kit, colour white (Rough brackets, not painted): 1 Bleed valve 3/4"; 1 Rh blanking plug; 1 Lh blanking plug; 2 Rh adapters 3/4"; 2 Lh adapters 3/4"; 4 O-ring seals; 2 Supporting brackets	550119
	A 30/1 Rubber lockshield plug (water diaphragm)	521011
	A 32/1 O-ring seal for nipples, plugs and adapters	530102
	A 33/1 Nipple for home furnishing radiators	521012
	A 36/4 4 Element towel rail - Colour: White RAL 9010	570014
	A 36/5 5 Element towel rail - Colour: White RAL 9010	570024
	A 36/6 6 Element towel rail - Colour: White RAL 9010	570124

For other accessories, see from page 65



Low thermal inertia



Low water content



Versatility



Easy to stock and install



16
bar

Maximum working pressure



Standard supply	3, 5, 7, 9 sections
Colours	PURE WHITE RAL 9010
Maximum working pressure	16 bar
Test pressure	24 bar
Included in the package	Water diaphragm (retainer cap)

All models **Garda S/90 AC** are guaranteed **10 years** from installation date on manufacturing faults, provided that the installation has been performed in compliance with the current norms and respecting the instructions relating to the installation, the correct use and the correct maintenance as illustrated on this catalogue.

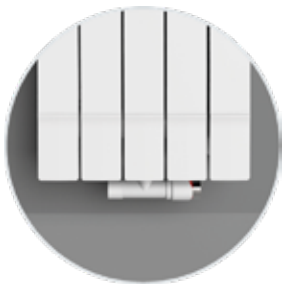

BOTTOM CENTRE CONNECTION



BOTTOM SIDE CONNECTION

To connect the radiator with a valve at the bottom on one side, you will need to join two Garda S/90 AC radiators using dedicated accessories
Art. 550111E + Art. 520118.

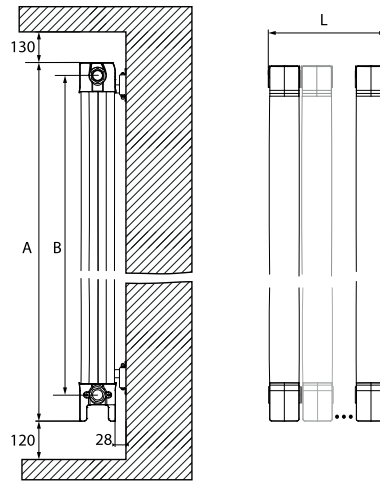

MEASURES EXPRESSED IN MILLIMETRES

Model	Heat output					
	ΔT 20	ΔT 30	ΔT 40	ΔT 50	ΔT 60	ΔT 70
	W/sect.	W/sect.	W/sect.	W/sect.	W/sect.	W/sect.
1200/3	192	334	494	669	857	1058
1200/5	320	556	823	1115	1429	1763
1200/7	449	779	1152	1561	2001	2468
1200/9	577	1001	1481	2007	2572	3173
1400/3	216	374	554	750	961	1185
1400/5	359	624	923	1250	1602	1975
1400/7	503	874	1292	1750	2242	2765
1400/9	647	1123	1661	2250	2883	3555

Model	Heat output					
	ΔT 20	ΔT 30	ΔT 40	ΔT 50	ΔT 60	ΔT 70
	W/sect.	W/sect.	W/sect.	W/sect.	W/sect.	W/sect.
1600/3	233	408	607	825	1064	1318
1600/5	388	680	1012	1375	1774	2196
1600/7	543	951	1417	1925	2484	3074
1600/9	698	1223	1822	2475	3193	3953
1800/3	260	450	665	900	1153	1421
1800/5	433	750	1108	1500	1921	2368
1800/7	606	1050	1551	2100	2689	3315
1800/9	779	1350	1995	2700	3458	4262

Model	Code	Depth	Height	Centre distance	Length *	Connection diameters	Water capacity	Exponent	Coefficient
		mm	(B) mm	(A) mm	(L) mm	inches	litres/sect.	n	Km
1200/3	83CF1403	90	1287	1187	260	G1/2	1,65	1,3610	3,2592
1200/5	83CF1405	90	1287	1187	420	G1/2	2,75	1,3610	5,4320
1200/7	83CF1407	90	1287	1187	580	G1/2	3,85	1,3610	7,6048
1200/9	83CF1409	90	1287	1187	740	G1/2	4,95	1,3610	9,7776
1400/3	83DF1403	90	1487	1387	260	G1/2	1,86	1,3600	3,6681
1400/5	83DF1405	90	1487	1387	420	G1/2	3,10	1,3600	6,1135
1400/7	83DF1407	90	1487	1387	580	G1/2	4,34	1,3600	8,5589
1400/9	83DF1409	90	1487	1387	740	G1/2	5,58	1,3600	11,0043
1600/3	83EF1403	90	1687	1587	260	G1/2	2,10	1,3843	3,6780
1600/5	83EF1405	90	1687	1587	420	G1/2	3,50	1,3843	6,1300
1600/7	83EF1407	90	1687	1587	580	G1/2	4,90	1,3843	8,5820
1600/9	83EF1409	90	1687	1587	740	G1/2	6,30	1,3843	11,034
1800/3	83FF1403	90	1887	1787	260	G1/2	2,34	1,3570	4,4538
1800/5	83FF1405	90	1887	1787	420	G1/2	3,90	1,3570	7,4230
1800/7	83FF1407	90	1887	1787	580	G1/2	5,46	1,3570	10,3922
1800/9	83FF1409	90	1887	1787	740	G1/2	7,02	1,3570	13,3614



* The measure includes the overall dimensions of the side caps.

Maximum working pressure: 1600 kpa (16 bar)



Characteristic equation of the model $\Phi=Km \Delta T^n$

Reference EN 442-1:2014.



50 mm centre distance valves with by-pass - **nickel-plated finish**

Item	Description	Code
	Angle valve with thermostat option	847V81210Q
	Straight valve with thermostat option	847V81610Q



50 mm centre distance valves with by-pass - **white finish**

Item	Description	Code
	Angle valve with thermostat option	847V81210E
	Straight valve with thermostat option	847V81610E





Complementary accessories

Item	Description	Code
	Extension kit with O-ring	550140
	Thermostatic head with liquid sensor - Colour: white/chrome	847A40300A
	Angle adapter for thermostatic head	847M02610A





Components supplied with the **radiator**

Item	Description	Code
	Fixing system kit and plugs	550128
	Blind plug with groove, 1" right thread	525013
	Blind plug with groove, 1" left thread	525113
	Reduction with groove, 1" ÷ ½ right thread	526241
	Reduction with groove, 1" ÷ ½ left thread	526341

Components supplied with the **valve**

Item	Description	Code
	Plastic probe 11 mm - 110 mm long	847NV81109A
	Flow diverter	847A31301A
	Nut and pipe union for valve - Colour: Chrome	847A34450B
	½" O-Ring for pipe union connection	847A15029A

Components for battery composition with **side connections**

Item	Description	Code
	½" Plug to close central element	520118
	Plastic wrench for plugs	560257
	Nipple metal wrench kit 1" and ¾" (50 cm) with lever and plastic wrench for plugs	550092
	Nipple metal wrench 1" (80 cm) without lever	550090
	Nipple metal wrench 1" (100 cm) without lever	550093

Copper pipe adapters

Pipe size	Connection	Nickel	Chrome
(Ø mm)		Code	Code
10	¾" EK	847A43301Q	847A33501B
12	¾" EK	847A43302Q	847A33502B
14	¾" EK	847A43303Q	847A33503B
15	¾" EK	847A43304Q	847A33504B
16	¾" EK	847A43305Q	847A33505B
18	¾" EK	-	847A33506B

**Multilayer pipe adapters**

Pipe size	Connection	Nickel	Chrome
(Ø mm)		Code	Code
14 x 2	¾" EK	847A39301Q	847A58701B
16 x 2	¾" EK	847A39302Q	847A58702B
17 x 2	¾" EK	847A39304Q	847A58704B
18 x 2	¾" EK	847A39306Q	847A58706B
20 x 2	¾" EK	847A39308Q	847A58708B
16 x 2.25	¾" EK	847A39303Q	847A58703B
20 x 2.25	¾" EK	847A39309Q	847A58709B
20 x 2.5	¾" EK	847A39307Q	847A58707B
16 x 2.6	¾" EK	847A39315Q	-
20 x 2.9	¾" EK	847A39316Q	-

**PEX pipe adapters**

Pipe size	Connection	Nickel	Chrome
(Ø mm)		Code	Code
12 x 1	¾" EK	847A39420Q	847A58810B
16 x 1.5	¾" EK	847A39405Q	847A58811B
12 x 2	¾" EK	847A39401Q	847A58800B
14 x 2	¾" EK	847A39402Q	847A58801B
16 x 2	¾" EK	847A39406Q	847A58803B
17 x 2	¾" EK	847A39408Q	847A58805B
18 x 2	¾" EK	847A39410Q	847A58806B
20 x 2	¾" EK	847A39413Q	847A58808B
16 x 2.2	¾" EK	847A39407Q	847A58804B
15 x 2.5	¾" EK	847A39404Q	847A58802B
18 x 2.5	¾" EK	847A39411Q	847A58807B
20 x 2.5	¾" EK	847A39415Q	847A58809B



По вопросам продаж и поддержки обращайтесь:

Алматы (7273)495-231
Ангарск (3955)60-70-56
Архангельск (8182)63-90-72
Астрахань (8512)99-46-04
Барнаул (3852)73-04-60
Белгород (4722)40-23-64
Благовещенск (4162)22-76-07
Брянск (4832)59-03-52
Владивосток (423)249-28-31
Владикавказ (8672)28-90-48
Владимир (4922)49-43-18
Волгоград (844)278-03-48
Вологда (8172)26-41-59
Воронеж (473)204-51-73
Екатеринбург (343)384-55-89
Иваново (4932)77-34-06
Ижевск (3412)26-03-58
Иркутск (395)279-98-46
Казань (843)206-01-48
Россия +7(495)268-04-70

Калининград (4012)72-03-81
Калуга (4842)92-23-67
Кемерово (3842)65-04-62
Киров (8332)68-02-04
Коломна (4966)23-41-49
Кострома (4942)77-07-48
Краснодар (861)203-40-90
Красноярск (391)204-63-61
Курск (4712)77-13-04
Липецк (4742)52-20-81
Магнитогорск (3519)55-03-13
Москва (495)268-04-70
Мурманск (8152)59-64-93
Набережные Челны (8552)20-53-41
Нижний Новгород (831)429-08-12
Новокузнецк (3843)20-46-81
Ноябрьск (3496)41-32-12
Новосибирск (383)227-86-73
Киргизия +996(312)-96-26-47

Омск (3812)21-46-40
Орел (4862)44-53-42
Оренбург (3532)37-68-04
Пенза (8412)22-31-16
Петрозаводск (8142)55-98-37
Псков (8112)59-10-37
Пермь (342)205-81-47
Ростов-на-Дону (863)308-18-15
Рязань (4912)46-61-64
Самара (846)206-03-16
Саранск (8342)22-96-24
Санкт-Петербург (812)309-46-40
Саратов (845)249-38-78
Севастополь (8692)22-31-93
Симферополь (3652)67-13-56
Смоленск (4812)29-41-54
Сочи (862)225-72-31
Ставрополь (8652)20-65-13
Сургут (3462)77-98-35
Казахстан +7(7172)727-132

Сыктывкар (8212)25-95-17
Тамбов (4752)50-40-97
Тверь (4822)63-31-35
Тольятти (8482)63-91-07
Томск (3822)98-41-53
Тула (4872)33-79-87
Тюмень (3452)66-21-18
Ульяновск (8422)24-23-59
Улан-Удэ (3012)59-97-51
Уфа (347)229-48-12
Хабаровск (4212)92-98-04
Чебоксары (8352)28-53-07
Челябинск (351)202-03-61
Череповец (8202)49-02-64
Чита (3022)38-34-83
Якутск (4112)23-90-97
Ярославль (4852)69-52-93